

masutti copat®

PRATELEIRAS METÁLICAS



Existem diversas formas de instalação e de aplicação das prateleiras metálicas. Abaixo algumas sugestões para você se inspirar:

FIXAÇÃO EMBUTIDA NO PAINEL

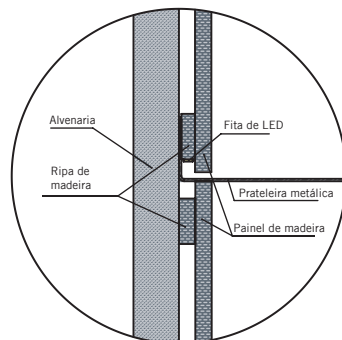
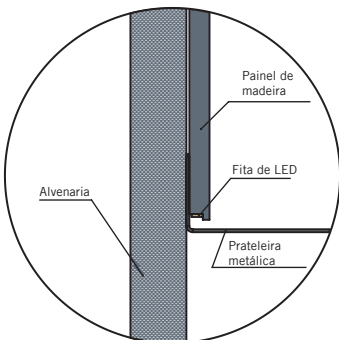
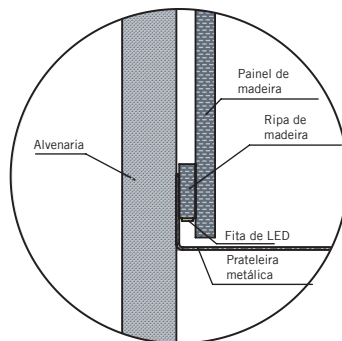
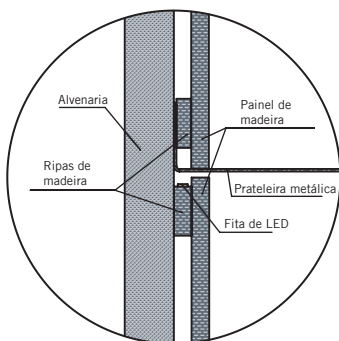

FIXAÇÃO DIRETA NO PAINEL OU ALVENARIA

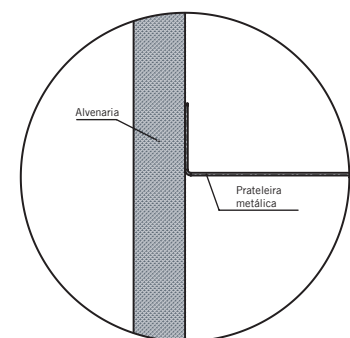
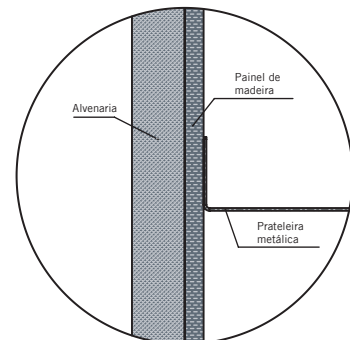
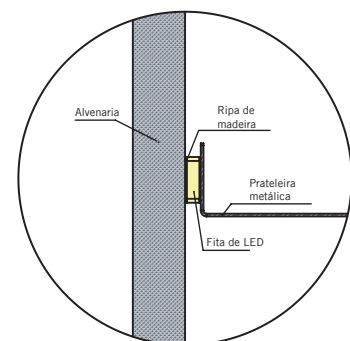

DICA:

Em qualquer opção de instalação as prateleiras podem ser usadas de forma “invertida”